



RESCO

S.R.L. 20054 Nova Milanese (MI) - Italy - Via L. Galvani, 18
Phone+39 0362 364425-Fax +39 0362 40907-E-mail:resco@resco.it



DECLARATION OF CONFORMITY

We:
RESCO SRL
Via Galvani, 18
20054 Nova Milanese (MI)

declare, accepting full responsibility, that the product:

MOD: DRYING MACHINE
TYPE : **ROLLER DRYER ML + E**
SERIES: **RTE020612060**

to which this declaration relates conforms with the following standard:

- EN 292-1
- EN 292-2
- EN 294
- EN 60-204
- EN 418
- EN 349
- prEN 811
- prEN 894-1
- prEN 894-2
- prEN 894-3
- prEN 953
- prEN 954
- prEN 1050
- prEN 50099-1

ŘÍZENÝ DOKUMENT

Výtisk č. **53e**

in accordance with the provisions of the CEE directive:

DIRETTIVA MACCHINE 89/392 CON EMENDAMENTO 91/368, 93/44, 93/68, 93/44, 93/68 e alla direttiva 89/336/EMC (compatibilità elettromagnetica) e successivi emendamenti 92/31 CEE e 93/68.

Date: 25.06.2002

RESCO s.r.l.



RESCO

® Machines for Multilayers and other Professional P. C. Boards

Sede legale Via degli Scipioni, 6 - 20151 Milano Italy C.F. e P.IVA 10975850156 - Trib. Milano Reg. Soc. 337315
C.C.I.A.A. Milano n. 1425687 - Banca Popolare di Milano Ag. 17 - MI c/c 17190 - Capitale Sociale 70.000.000

KAWA

Leiterplattentechnik / Industrievertretung

7 TECHNICAL DATA

| | |
|-------------------------|--------------|
| Conveyor width | 620 mm |
| Working height | 960 mm |
| Smallest board size | 100 x 120 mm |
| Largest board size | 610 x ∞ mm |
| Highest board thickness | 4 mm |
| Water consumption | <10 lt/h |
| Power supply | 5 kW |
| Width of the machine | 1265 mm |
| Length of the machine | 720 mm |
| Height of the machine | 1100 mm |
| Net weight | 200 kg |

Conveyor speed stepless adjustable.

Automatic temperature control by means of built-in heaters and thermometer.



RESCO

S.R.L. 20054 Nova Milanese (MI) - Italy - Via L. Galvani, 18
Phone+39 0362 364425-Fax +39 0362 40907-E-mail:resco@resco.it



DECLARATION OF CONFORMITY

We:

RESCO SRL

Via Galvani, 18

20054 Nova Milanese (MI)

declare, accepting full responsibility, that the product:

MOD: DRYING MACHINE

TYPE : **ROLLER DRYER ML**

SERIES: **RTE020611960**

to which this declaration relates conforms with the following standard:

EN 292-1

EN 292-2

EN 294

EN 60-204

EN 418

EN 349

prEN 811

prEN 894-1

prEN 894-2

prEN 894-3

prEN 953

prEN 954

prEN 1050

prEN 50099-1

ŘÍZENÝ DOKUMENT

Výtisk č. 53 f

in accordance with the provisions of the CEE directive:

DIRETTIVA MACCHINE 89/392 CON EMENDAMENTO 91/368, 93/44, 93/68, 93/44, 93/68 e alla direttiva 89/336/EMC (compatibilità elettromagnetica) e successivi emendamenti 92/31 CEE e 93/68.

Date: 25.06.2002

RESCO s.r.l.



RESCO

® Machines for Multilayers and other Professional P. C. Boards

Sede legale Via degli Scipioni, 6 - 20151 Milano Italy C.F. e P.IVA 10975850156 - Trib. Milano Reg. Soc. 337315
C.C.I.A.A. Milano n. 1425687 - Banca Popolare di Milano Ag. 17 - MI c/c 17190 - Capitale Sociale 70.000.000

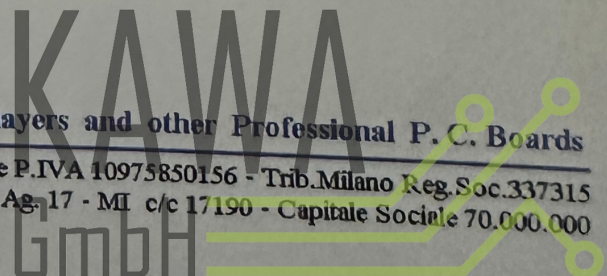

Leiterplattentechnik / Industrievertretung

7 TECHNICAL DATA

| | |
|-------------------------|--------------|
| Conveyor width | 620 mm |
| Working height | 960 mm |
| Smallest board size | 100 x 120 mm |
| Largest board size | 610 x ∞ mm |
| Highest board thickness | 4 mm |
| Water consumption | <10 lt/h |
| Power supply | 5 kW |
| Width of the machine | 1265 mm |
| Length of the machine | 720 mm |
| Height of the machine | 1100 mm |
| Net weight | 200 kg |

Conveyor speed stepless adjustable.

Automatic temperature control by means of built-in heaters and thermometer.



RESCO

S.R.L. 20054 Nova Milanese (MI) - Italy - Via L. Galvani, 18
Phone+39 0362 364425-Fax +39 0362 40907-E-mail:resco@resco.it

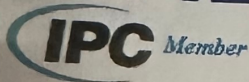

DECLARATION OF CONFORMITY

We:

RESCO SRL
Via Galvani, 18
20054 Nova Milanese (MI)

declare, accepting full responsibility, that the product:

MOD: DRYING MACHINE
TYPE : ROLLER DRYER ML
SERIES: RTE041019160

to which this declaration relates conforms with the following standard:

- EN 292-1
- EN 292-2
- EN 294
- EN 60-204
- EN 418
- EN 349
- prEN 811
- prEN 894-1
- prEN 894-2
- prEN 894-3
- prEN 953
- prEN 954
- prEN 1050
- prEN 50099-1

in accordance with the provisions of the CEE directive:

DIRETTIVA MACCHINE 89/392 CON EMENDAMENTO 91/368, 93/44, 93/68,93/44, 93/68 e alla direttiva 89/336/EMC (compatibilità elettromagnetica) e successivi emendamenti 92/31 CEE e 93/68.

Date: 17.01.05



RESCO

® Machines for Multilayers and other Professional P. C. Boards

Sede legale Via degli Scipioni, 6 - 20151 Milano Italy C.F. e P.IVA 10975850156 - Trib. Milano Reg. Soc. 337315
C.C.I.A.A. Milano n. 1425687 - Banca Popolare di Milano Ag. 17 - MI c/c 17190 - Capitale Sociale 70.000.000

KAWA

Leiterplattentechnik / Industrievertretung

TECHNICAL DATA

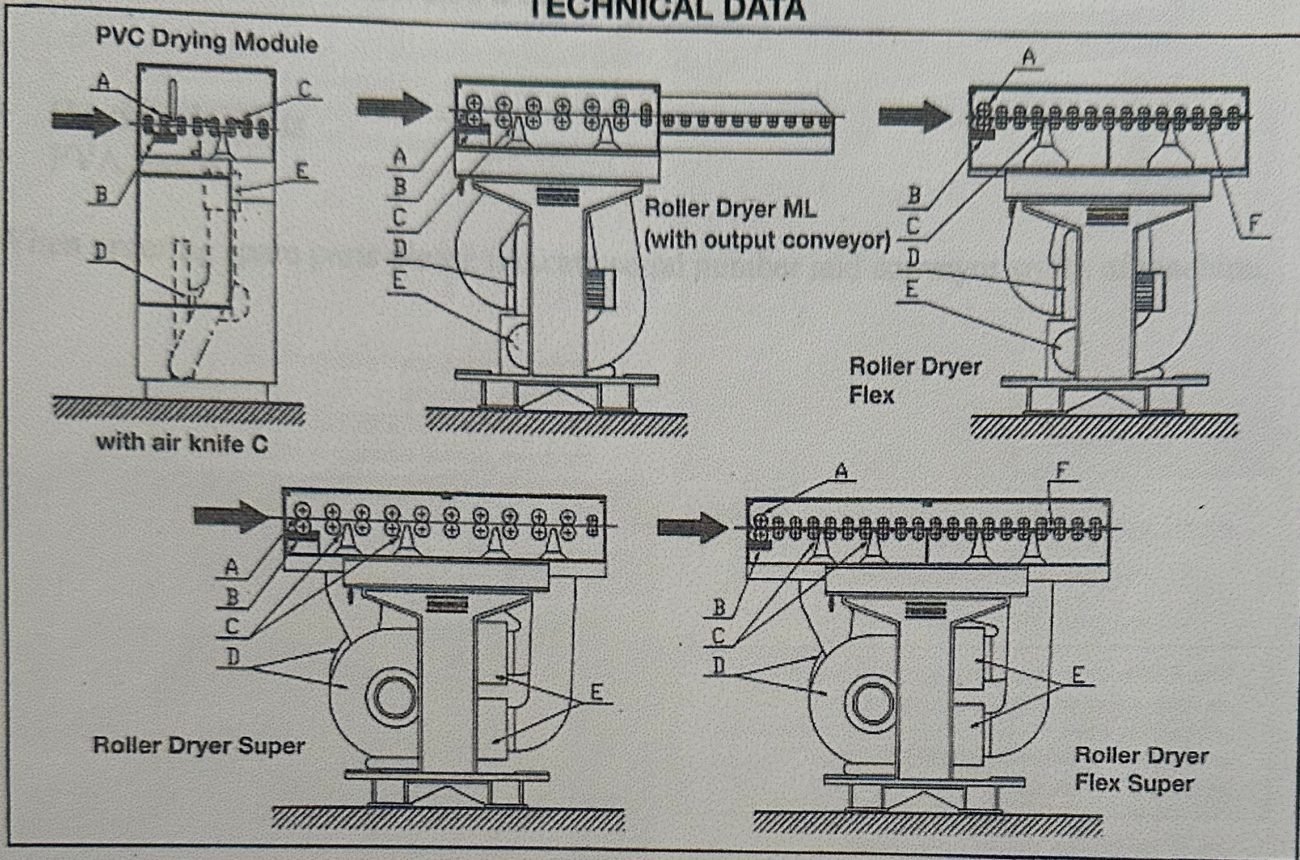

Legend:

- | | |
|---|------------------------------------|
| A: Pair of strongly absorbent rollers with tanks for water. | D: Powerful air blower. |
| B: Water tank for the continuous cleaning of the pair of rollers. | E: Heating with hot-air nozzles. |
| C: Suction device. | F: Conveyor for flexible circuits. |

| | PVC Drying Module | Roller Dryer ML | Roller Dryer ML Super | Roller Dryer Flex | Roller Dryer Flex Super |
|---|-------------------|-----------------|-----------------------|-------------------|-------------------------|
| - Working width | 620 mm. | 620 mm. | 620 mm. | 620 mm. | 620 mm. |
| - Working height | 960 mm. | 960 mm. | 960 mm. | 960 mm. | 960 mm. |
| - Speed (stepless) | 0-2 mt/min. | 0-2 mt/min. | 0-3 mt/min. | 0-2 mt/min. | 0-3 mt/min. |
| - Heating elements | 2x1 KW | 3x1 KW | 6x1 KW | 3x1 KW | 6x1 KW |
| - Total power installed | 3 KW | 4 KW | 8 KW | 4 KW | 8 KW |
| - Width of machine | 1060 mm. | 1160 mm. | 1160 mm. | 1160 mm. | 1160 mm. |
| - Length of machine | 510 mm. | 710 mm. | 1110 mm. | 960 mm. | 1260 mm. |
| - Height of machine | 1170 mm. | 1060 mm. | 1060 mm. | 1060 mm. | 1060 mm. |
| - Additional length with out- or input | 600 mm. | 600 mm. | 600 mm. | 600 mm. | 600 mm. |
| - Additional length with in-built stacker | 735 mm. | 735 mm. | 735 mm. | 735 mm. | 600 mm. |
| - Net weight | 80 kg. | 150 kg. | 190 kg. | 120 kg. | 170 kg. |
| - Max temperature of hot air | 45°C | 70°C | 70°C | 70°C | 70°C |

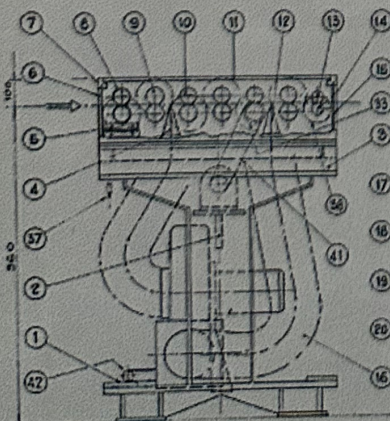

KAWA

Its time-tested and extremely sturdy construction ensures reliability of service. Spare parts are mainly the same as for the Resotron brushing machines and are clearly described in the fully detailed instructions.

DECLARATION OF CONFORMITY

We:

RESCO SRL
Via Massena 2/A
20145 MILANO

declare, accepting full responsibility, that the product:

MOD.: DEVELOPING MACHINE

TYPE: ADF DEVELOPER 50

SERIES: RE98113160

to which this declaration relates conforms with the following standard:

EN 292-1
EN 292-2
EN 294
EN 60-204
EN 418
EN 349
prEN 811
prEN 894-1
prEN 894-2
prEN 894-3
prEN 953
prEN 954
prEN 1050
prEN 50099-1

in accordance with the provisions of the CEE directive:

DIRETTIVA MACCHINE 89/392 CON EMENDAMENTO 91/368, 93/44, 93/68, 93/44, 93/68 e
alla direttiva 89/336/EMC (compatibilità elettromagnetica) e successivi emendamenti 92/31 CEE e
93/68.

Date: 10.11.98

RESCO s.r.l.

RESCO Machines for Multilayers and other Professional P.C. Boards

Sede legale Via degli Scipioni, 6 - 20129 Milano Italy C.F. e P. IVA T0975850156 - Trib. Milano Reg. Soc. 337315
C.C.I.A.A. Milano n. 1425687 - Banca Popolare di Milano Ag. 17 - MI c/e 17190 - Capitale Sociale 70.000.000

Leiterplattentechnik / Industrievertretung

3.

2. TECHNICAL DATA

| | |
|--------------------------------------|--|
| Power required | 16 kw/220-380 V/50 Hz |
| Water consumption. | l/min. 8 (16 max) |
| Conveyor width. | 62 cm. |
| Conveyor height | 96 cm. |
| Tank capacity 1.st station | 270 l |
| Tank capacity 2.nd station | 150 l |
| Smallest board size. | 100 x 120 mm |
| Floor area required. | 2970 x 1325 mm |
| Net weight | 580 kg. |
| Conveyor speed | from 0 - 200 cm. step- less adjustable |



RESCO

SRL 20054 Nova Milanese (MI) - Italy - Via L. Galvani, 18
Phone+39 0362 364425-Fax +39 0362 40907-E-mail:resco@resco.it



DECLARATION OF CONFORMITY

We:

RESCO SRL
Via Galvani, 18
20054 Nova Milanese (MI)

declare, accepting full responsibility, that the product:

MOD: DIVERTER
TYPE : 90° DIVERTER
SERIES: RTE020612260

to which this declaration relates conforms with the following standard:

- EN 292-1
- EN 292-2
- EN 294
- EN 60-204
- EN 418
- EN 349
- prEN 811
- prEN 894-1
- prEN 894-2
- prEN 894-3
- prEN 953
- prEN 954
- prEN 1050
- prEN 50099-1

ŘÍZENÝ DOKUMENT

Výtisk č. 53d

in accordance with the provisions of the CEE directive:

DIRETTIVA MACCHINE 89/392 CON EMENDAMENTO 91/368, 93/44, 93/68,93/44, 93/68 e alla direttiva 89/336/EMC (compatibilità elettromagnetica) e successivi emendamenti 92/31 CEE e 93/68.

Date: 25.06.2002

RESCO s.r.l.



RESCO

® Machines for Multilayers and other Professional P. C. Boards

Sede legale Via degli Scipioni, 6 - 20151 Milano Italy C.F. e P.IVA 10975850156 - Trib.Milano Reg.Soc.337315
C.C.L.A.A. Milano n. 1425687 - Banca Popolare di Milano Ag. 17 - MI c/c 17190 - Capitale Sociale 70.000.000

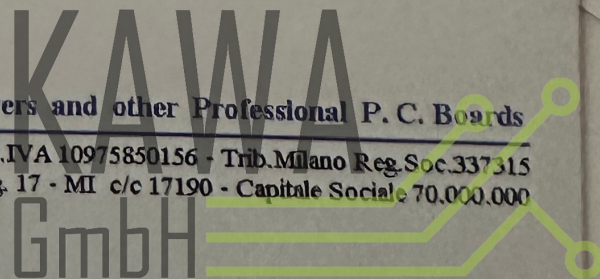

Leiterplattentechnik / Industrievertretung

7 TECHNICAL DATA

| | |
|-------------------------|--------------|
| Conveyor width | 620 mm |
| Working height | 960 mm |
| Smallest board size | 120 x 120 mm |
| Largest board size | 610 x 610 mm |
| Highest board thickness | - mm |
| Air consumption | <50 lt/min |
| Power supply | 1 kW |
| Width of the machine | mm |
| Length of the machine | mm |
| Height of the machine | mm |
| Net weight | 150 kg |
| Gross weight | 200 kg |

Conveyor speed stepless adjustable.

Automatic level control by means of built-in sensors and pump.

7.1 Deviator belts drive motor

| | Builder | Description |
|-------------|--------------|-----------------------------------|
| Gear box | Bonfiglioli | MVF30/A i=60 mounting position B3 |
| Motor | SAROK Italia | Type 50/31 3000rpm 170VdC 80W |
| Convertitor | TIB | |

7.2 Straight on conveyor drive motor

| | Builder | Description |
|-------------|--------------|-----------------------------------|
| Gear box | Bonfiglioli | MVF30/A i=60 mounting position B3 |
| Motor | SAROK Italia | Type 50/28 3000rpm 170VdC 80W |
| Convertitor | TIB | |



RESCO

S.R.L. 20054 Nova Milanese (MI) - Italy - Via L. Galvani, 18
Phone+39 0362 364425-Fax +39 0362 40907-E-mail:resco@resco.it



DECLARATION OF CONFORMITY

We:

RESCO SRL

Via Galvani, 18

20054 Nova Milanese (MI)

declare, accepting full responsibility, that the product:

MOD: CONVEYOR

TYPE : **TWO METER CONVEYOR**

SERIES: **RTE020612360**

to which this declaration relates conforms with the following standard:

EN 292-1

EN 292-2

EN 294

EN 60-204

EN 418

EN 349

prEN 811

prEN 894-1

prEN 894-2

prEN 894-3

prEN 953

prEN 954

prEN 1050

prEN 50099-1

in accordance with the provisions of the CEE directive:

DIRETTIVA MACCHINE 89/392 CON EMENDAMENTO 91/368, 93/44, 93/68, 93/44, 93/68 e alla direttiva 89/336/EMC (compatibilità elettromagnetica) e successivi emendamenti 92/31 CEE e 93/68.

Date: 25.06.2002

RESCO s.r.l.



RESCO

® Machines for Multilayers and other Professional P. C. Boards

Sede legale Via degli Scipioni, 6 - 20151 Milano Italy C.F. e P.IVA 10975850156 - Trib. Milano Reg. Soc. 337315
C.C.I.A.A. Milano n. 1425687 - Banca Popolare di Milano Ag. 17 - MI c/c 17190 - Capitale Sociale 70.000.000

KAWA

Leiterplattentechnik / Industrievertretung



RESCO

S.R.L. 20054 Nova Milanese (MI) - Italy - Via L. Galvani, 18
Phone+39 0362 364425-Fax +39 0362 40907-E-mail:resco@resco.it



DECLARATION OF CONFORMITY

We:

RESCO SRL

Via Galvani, 18

20054 Nova Milanese (MI)

declare, accepting full responsibility, that the product:

MOD: DIVERTER

TYPE : 90° DIVERTER

SERIES: RTE020612160

to which this declaration relates conforms with the following standard:

EN 292-1

EN 292-2

EN 294

EN 60-204

EN 418

EN 349

prEN 811

prEN 894-1

prEN 894-2

prEN 894-3

prEN 953

prEN 954

prEN 1050

prEN 50099-1

ŘÍZENÝ DOKUMENT

Výtisk č. 53 c.

in accordance with the provisions of the CEE directive:

DIRETTIVA MACCHINE 89/392 CON EMENDAMENTO 91/368, 93/44, 93/68,93/44, 93/68 e alla direttiva 89/336/EMC (compatibilità elettromagnetica) e successivi emendamenti 92/31 CEE e 93/68.

Date: 25.06.2002

RESCO s.r.l.



RESCO

® Machines for Multilayers and other Professional P. C. Boards

Sede legale Via degli Scipioni, 6 - 20151 Milano Italy C.F. e P.IVA 10975850156 - Trib. Milano Reg. Soc. 337315
C.C.I.A.A. Milano n. 1425687 - Banca Popolare di Milano Ag. 17 - MI c/c 17190 - Capitale Sociale 70.000.000

KAWA
GmbH

Leiterplattentechnik / Industrievertretung

7 TECHNICAL DATA

| | |
|-------------------------|--------------|
| Conveyor width | 620 mm |
| Working height | 960 mm |
| Smallest board size | 120 x 120 mm |
| Largest board size | 610 x 610 mm |
| Highest board thickness | - mm |
| Air consumption | <50 lt/min |
| Power supply | 1 kW |
| Width of the machine | mm |
| Length of the machine | mm |
| Height of the machine | mm |
| Net weight | 150 kg |
| Gross weight | 200 kg |

Conveyor speed stepless adjustable.

Automatic level control by means of built-in sensors and pump.

7.1 Deviator belts drive motor

| | Builder | Description |
|-------------|--------------|-----------------------------------|
| Gear box | Bonfiglioli | MVF30/A i=60 mounting position B3 |
| Motor | SAROK Italia | Type 50/31 3000rpm 170VdC 80W |
| Convertitor | TIB | |

7.2 Straight on conveyor drive motor

| | Builder | Description |
|-------------|--------------|-----------------------------------|
| Gear box | Bonfiglioli | MVF30/A i=60 mounting position B3 |
| Motor | SAROK Italia | Type 50/28 3000rpm 170VdC 80W |
| Convertitor | TIB | |



RESCO

S.R.L. 20054 Nova Milanese (MI) - Italy - Via L. Galvani, 18
Phone+39 0362 364425-Fax +39 0362 40907-E-mail:resco@resco.it



DECLARATION OF CONFORMITY

We:

RESCO SRL
Via Galvani, 18
20054 Nova Milanese (MI)

declare, accepting full responsibility, that the product:

MOD: ETCHING MACHINE
TYPE : E 1000 2R TFS
SERIES: RTE020612460

to which this declaration relates conforms with the following standard:

- EN 292-1
- EN 292-2
- EN 294
- EN 60-204
- EN 418
- EN 349
- prEN 811
- prEN 894-1
- prEN 894-2
- prEN 894-3
- prEN 953
- prEN 954
- prEN 1050
- prEN 50099-1

ŘÍZENÝ DOKUMENT

Výtisk č. **53**

in accordance with the provisions of the CEE directive:

DIRETTIVA MACCHINE 89/392 CON EMENDAMENTO 91/368, 93/44, 93/68,93/44, 93/68 e alla direttiva 89/336/EMC (compatibilità elettromagnetica) e successivi emendamenti 92/31 CEE e 93/68.

Date: 25.06.2002

RESCO



RESCO

® Machines for Multilayers and other Professional P. C. Boards

Sede legale Via degli Scipioni, 6 - 20151 Milano Italy C.F. e P.IVA 10975850156 - Trib. Milano Reg. Soc. 337315
C.C.I.A.A. Milano n. 1425687 - Banca Popolare di Milano Ag. 17 - MI c/c 17190 - Capitale Sociale 70.000.000

KAWA

Leiterplattentechnik / Industrievertretung



RESCO

S.R.L. 20054 Nova Milanese (MI) - Italy - Via L. Galvani, 18
Phone+39 0362 364425-Fax +39 0362 40907-E-mail:resco@resco.it



DECLARATION OF CONFORMITY

We:

RESCO SRL

Via Galvani, 18

20054 Nova Milanese (MI)

declare, accepting full responsibility, that the product:

MOD: RINSING MACHINE

TYPE : MULTIRINSE 3

SERIES: RTE020612560

to which this declaration relates conforms with the following standard:

EN 292-1

EN 292-2

EN 294

EN 60-204

EN 418

EN 349

prEN 811

prEN 894-1

prEN 894-2

prEN 894-3

prEN 953

prEN 954

prEN 1050

prEN 50099-1

in accordance with the provisions of the CEE directive:

DIRETTIVA MACCHINE 89/392 CON EMENDAMENTO 91/368, 93/44, 93/68,93/44, 93/68 e alla direttiva 89/336/EMC (compatibilità elettromagnetica) e successivi emendamenti 92/31 CEE e 93/68.

Date: 25.06.2002

RESCO S.R.L.



RESCO

® Machines for Multilayers and other Professional P. C. Boards

Sede legale Via degli Scipioni, 6 - 20151 Milano Italy C.F. e P.IVA 10975850156 - Trib.Milano Reg.Soc.337315
C.C.I.A.A. Milano n. 1425687 - Banca Popolare di Milano Ag. 17 - MI c/c 17190 - Capitale Sociale 70.000.000

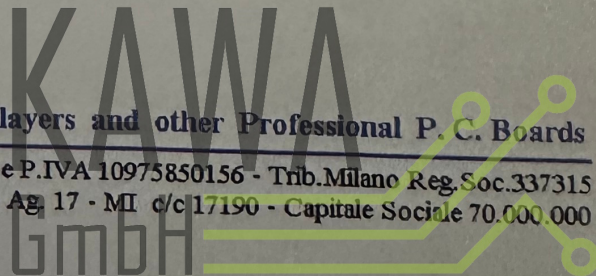

Leiterplattentechnik / Industrievertretung

MACCHINE O MODULI MACHINES OR MODULES

| | COMPACT ETCHER | COMPACT ETCHER HVP | E 1000 | E 1500 | E 2000 | ERS STATION | «2R» STATION | «3R» STATION | W STATION | MLTR 1 | MLTR 2 | MLTR 3 | MLTR 4 | MLTR 5 |
|--|-------------------------------------|--------------------|----------------|----------------|-----------------|---------------|---------------|---------------|----------------|---------------|---------------|---------------|---------------|---------------|
| Capacità produttiva c* Production capacity c* | m ² /h a* 10 b* 18 | a* 17 b* 30 | a* 18 b* 33 | a* 27 b* 49 | a* 36 b* 66 | - | - | - | - | - | - | - | - | - |
| Lunghezza macchina / stazione Machine station length | mm 1710 | 2070 | 1895 | 2375 | 2790 | 355 | 360 | 535 | 300 | 870 | 1110 | 1350 | 1590 | 1830 |
| Larghezza max macchina Max machine width | mm 1400 | 1400 | 1400 | 1400 | 1400 | - | - | - | - | 1400 | 1400 | 1400 | 1400 | 1400 |
| Altezza di lavoro Working height | mm 960 | 960 | 960 | 960 | 960 | 960 | 960 | 960 | 960 | 960 | 960 | 960 | 960 | 960 |
| Larghezza utile di lavoro k* Working width k* | mm 610 | 610 | 610 | 610 | 610 | 610 | 610 | 610 | 610 | 610 | 610 | 610 | 610 | 610 |
| Capacità serbatoio Capacity tank | lt. 200 | 290 | 350 | 350 | 350 | - | 25 each | 25 each | -n* 60m* | 60 each | 60 each | 60 each | 60 each | 60 each |
| Lunghezza della camera di incisione Etching chamber length | mm 660 | 1020 | 1385 | 1865 | 2475 | - | - | - | - | - | - | - | - | - |
| Lunghezza utile (spruzzata) camera di incisione Etching chamber sprayed zone length | mm 540 | 900 | 1050 | 1540 | 1960 | - | - | - | - | - | - | - | - | - |
| Area spruzzata Sprayed area | m ² 0,33 | 0,55 | 0,65 | 0,93 | 1,20 | - | 0,07 | 0,1 | 0,07 | 0,07 | 0,14 | 0,21 | 0,28 | 0,35 |
| File totali di ugelli (sopra e sotto) camera di incisione Total nozzles lines (sup / inf) etching chamber | 18 | 30 | 30 | 44 | 56 | - | - | - | - | - | - | - | - | - |
| Numero totale ugelli (sup+inf) camera di incisione Total (sup+inf) number of nozzles etching chamber | 18 c* 36 f* | 30 c* 60 f* | 30 c* 60 f* | 44 c* 88 f* | 56 c* 112 f* | - | - | - | - | - | - | - | - | - |
| File totali di ugelli (sopra e sotto) zone di lavaggio Total nozzles lines (sup / inf) rinsing zone | 10 | 10 | - | - | - | - | - | - | 4 | 6 | 10 | 14 | 18 | 22 |
| Numero totale ugelli di lavaggio (sup+inf) Total (sup.+inf.) number of rinsing nozzles | 26 | 26 | - | - | - | - | - | - | 8 | 12 | 20 | 28 | 36 | 44 |
| Forza di impatto Impact power | gr/mm ² 0,2 | 0,2 | 0,2 | 0,2 | 0,2 | - | 0,1 | 0,1 | 0,3 | 0,3 | 0,3 | 0,3 | 0,3 | 0,3 |
| Sistema di spruzzo TFS per very fine lines TFS spray system for very fine lines | ■ | ■ | ■ | ■ | ■ | - | - | - | - | - | - | - | - | - |
| Zona ERS ERS zone | ● | ● | ■ | ■ | ■ | - | - | - | - | - | - | - | - | - |
| ↑ Sistema di replenishment Replenishment system | ■ | ■ | ■ | ■ | ■ | - | ● | ● | - | - | - | - | - | - |
| Numero delle stazioni di lavaggio Rinsing stations number | 2 | 2 | - | - | - | - | - | - | 1 | 2 d* | 3 d* | 4 d* | 5 d* | 6 d* |
| Consumo d'acqua massimo Max water consumption | lt/min 8 | 8 | - | - | - | - | - | - | 8 | 8 | 8 | 8 | 8 | 8 |
| Numero x potenza pompe Number x pump power | Kw 1x1,1+ 1x0,4 | 1x2,2+ 1x0,4 | 1x3,3 | 2x2,2 | 2x3,3 | - | 2x0,4 | 3x0,4 | -n* 1x0,4m* | 1x0,4 | 2x0,4 | 3x0,4 | 4x0,4 | 5x0,4 |
| Resistenza e riscaldamento camera di incisione Etching chamber heater | Kw 4 | 6 | 9 | 9 | 9 | - | - | - | - | - | - | - | - | - |
| Serpentina di raffreddamento Cooling coil | ● | ● | ● | ● | ● | - | - | - | - | - | - | - | - | - |
| Massima potenza totale richiesta Max total power required | Kw 6 | 9 | 13 | 14 | 16 | - | 0,8 | 1,2 | -n* 1x0,4m* | 1 | 2 | 2 | 3 | 3 |
| Asciugatrice incorporata Incorporated dryer | ■ | ■ | ○ | ○ | ○ | - | - | - | - | ○ | ○ | ○ | ○ | ○ |
| Formato massimo circuiti (larghezza x lunghezza) Max board dimensions (width x length) | mm 610x∞ | 610x∞ | 610x∞ | 610x∞ | 610x∞ | 610x∞ | 610x∞ | 610x∞ | 610x∞ | 610x∞ | 610x∞ | 610x∞ | 610x∞ | 610x∞ |
| Formato minimo circuiti (larghezza x lunghezza) Min board dimensions (width x length) | mm 20x120 | 20x120 | 20x120 | 20x120 | 20x120 | 20x120 | 20x120 | 20x120 | 20x120 | 20x120 | 20x120 | 20x120 | 20x120 | 20x120 |
| Spessore massimo dei circuiti Max board thickness | mm 4 h* | 4 h* | 4 h* | 4 h* | 4 h* | 4 h* | 4 h* | 4 h* | 4 h* | 4 h* | 4 h* | 4 h* | 4 h* | 4 h* |
| Spessore minimo circuiti Min board thickness | mm 0,05 i* j* | 0,05 i* j* | 0,05 i* j* | 0,05 i* j* | 0,05 i* j* | 0,05 i* j* | 0,05 i* j* | 0,05 i* j* | 0,05 i* j* | 0,05 i* j* | 0,05 i* j* | 0,05 i* j* | 0,05 i* j* | 0,05 i* j* |

NOTE: ○ non disponibile
not available
NOTE: ● incluso
included
NOTE: ■ non disponibile
not available

b*: 35 μ rame, soluzione ammoniacale
35 μ copper, ammoniacal solution
c*: calcolata al 75% della produttività teorica
calculated at 75% of theoretical production capacity
d*: di cui l'ultima non ricicolata
the last one not recycled
e*: sistema di spruzzo tipo «F»
spray system type «F»

f*: sistema di spruzzo tipo «TFS»
spray system type «TFS»
g*: sistema di spruzzo tipo «Scan»
spray system type «Scan»
h*: a richiesta spessori superiori
superior thickness on request
i*: per spessori inferiori a 0,1 mm è
necessaria la versione «flex»
for thickness below 0,1 mm the
«flex» version is needed

j*: 0,05 mm solo con rame su entrambe i lati
0,05 mm only with copper on both sides
k*: a richiesta larghezze da 750 mm o 1200 mm
width from 750 mm or 1200 mm on request
n*: se la stazione è collegata all'acqua di rete
if the station is connected to mains water
m*: se la stazione viene ricicolata con una pompa (Wr)
if the station is recycled with a pump (Wr)

I S
32 32

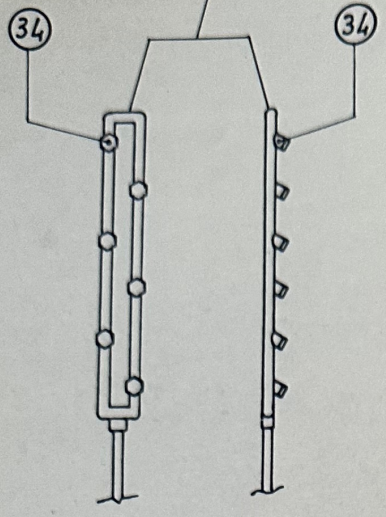

S I
33 33

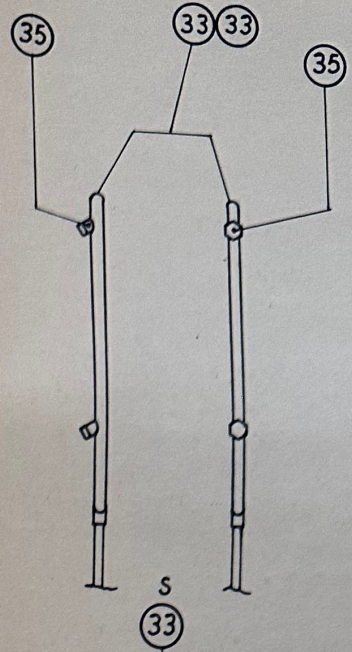

N° 5 Groupes

36

32

2260

320 300 300 300 300 300 240 200

IN

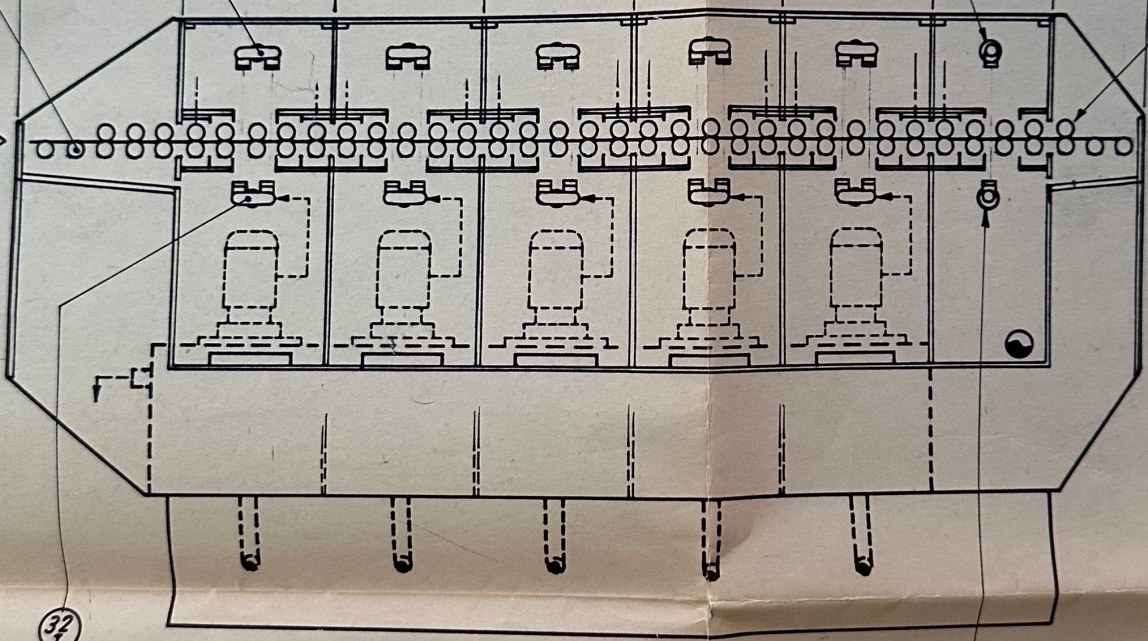

960

1170

32

N° 5 Groupes

48

33
I

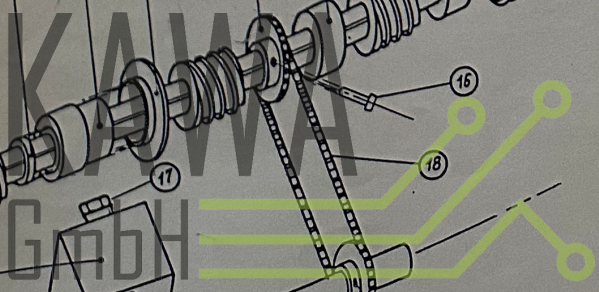
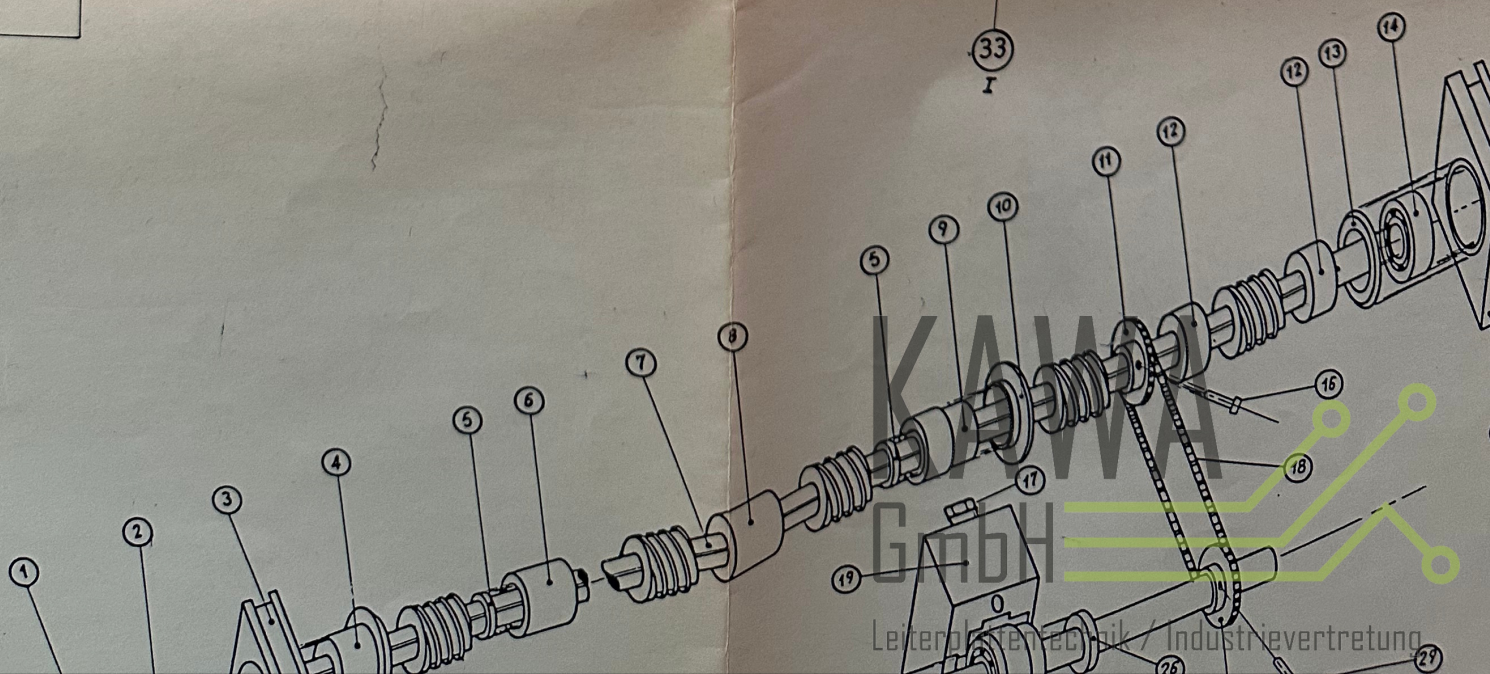

Leiterplatten-Technik / Industrievertretung

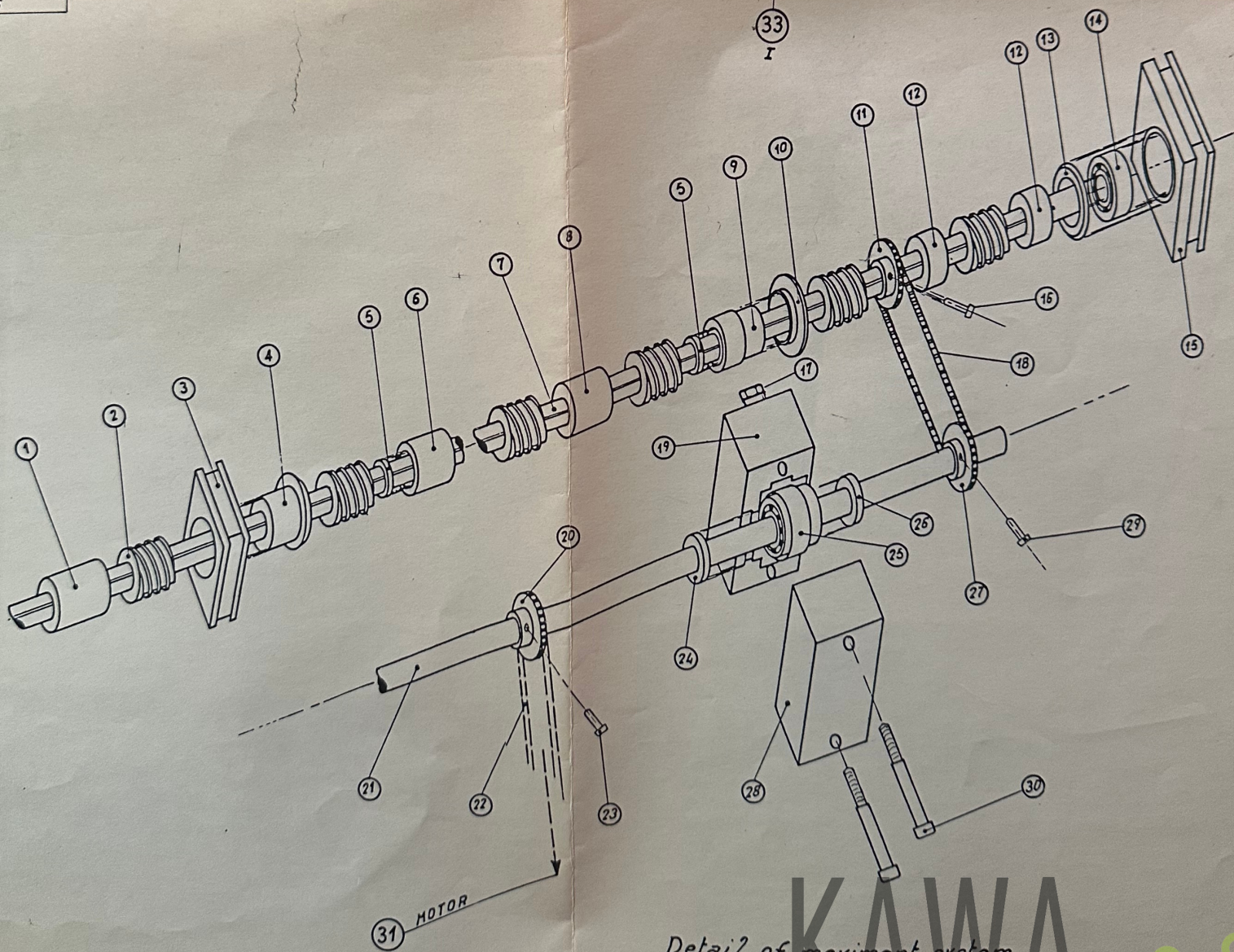
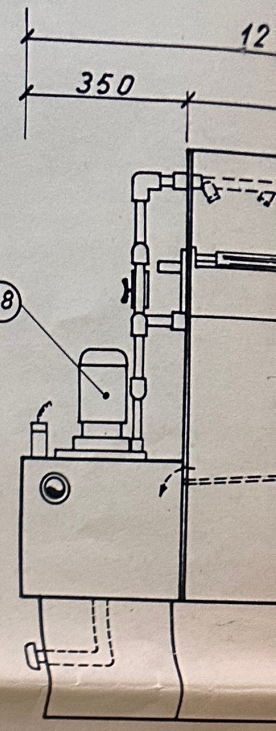
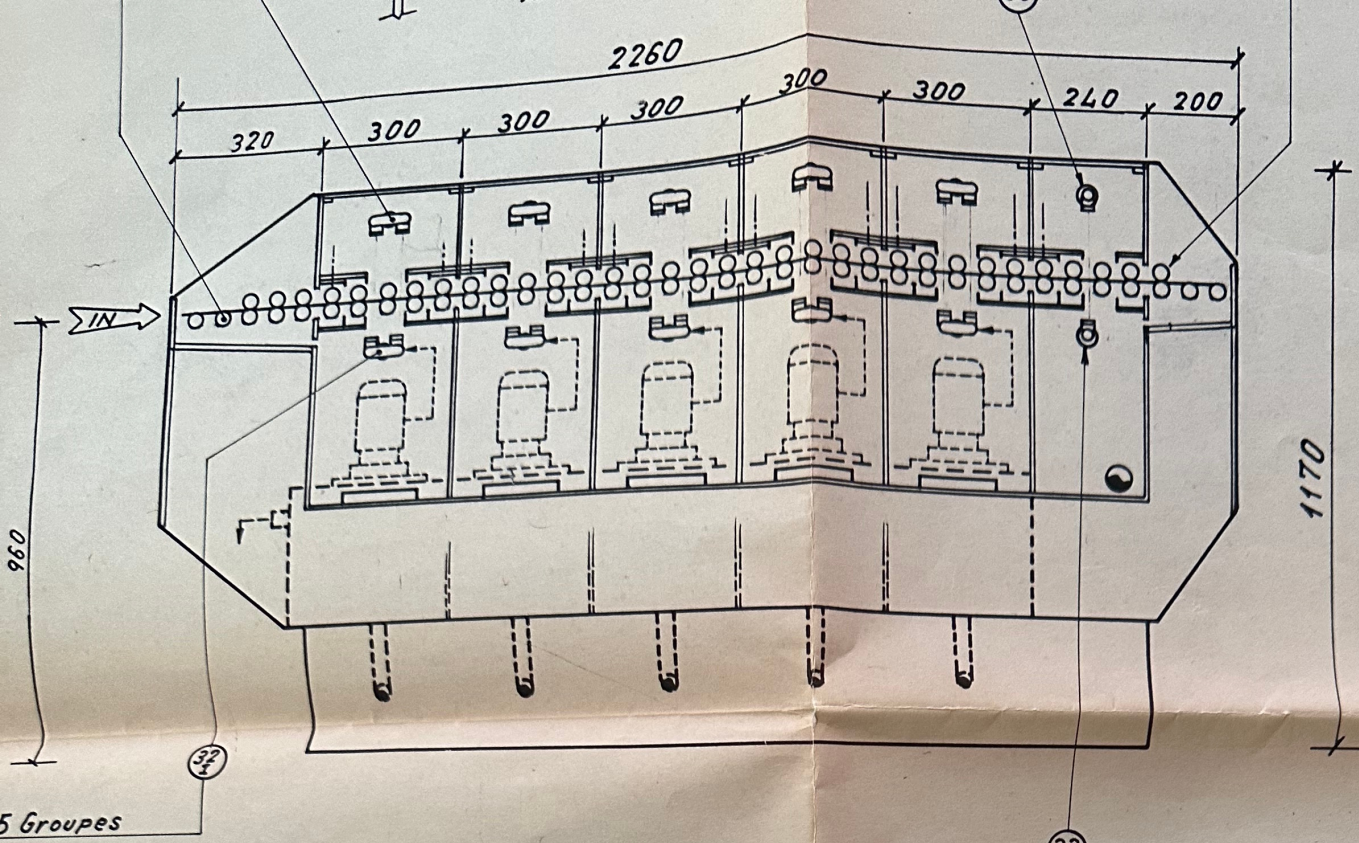

Detail of movement system

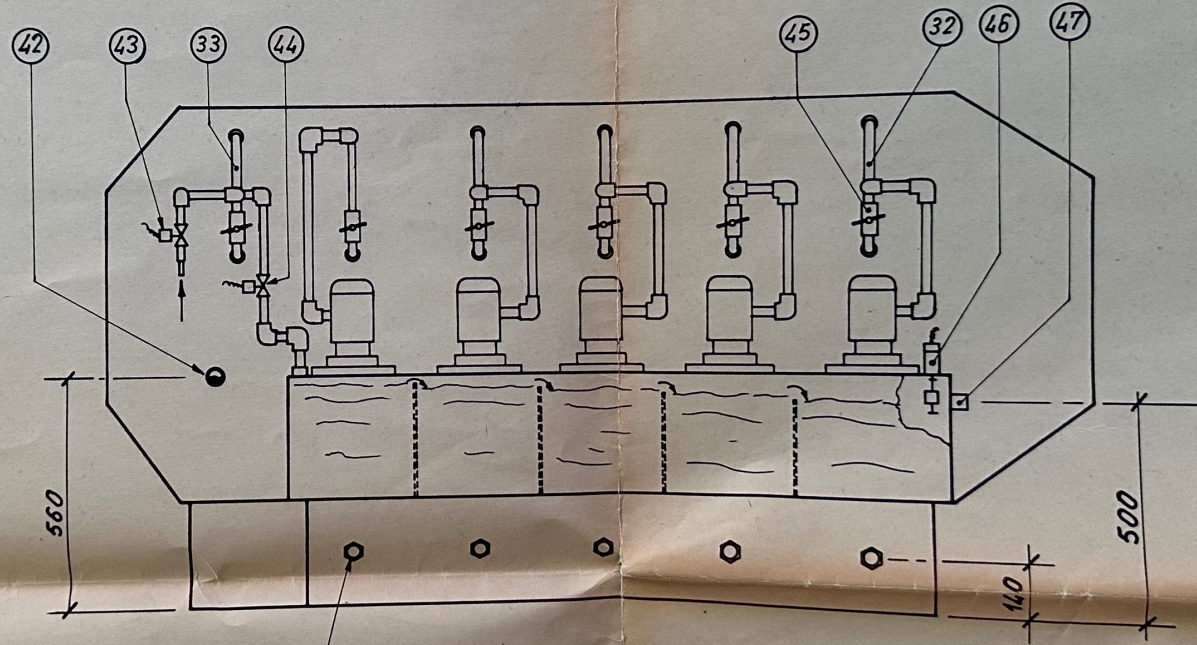
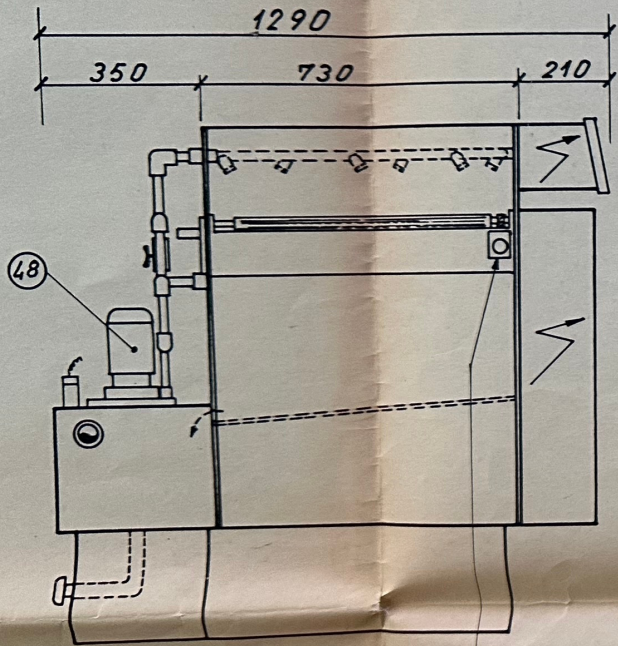

See detail of movement system

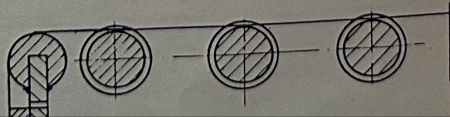
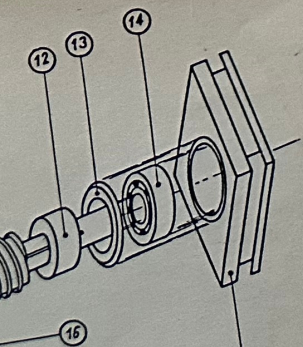

38
KAWA
GmbH

Leiterplatten-Technik / Industrievertretung

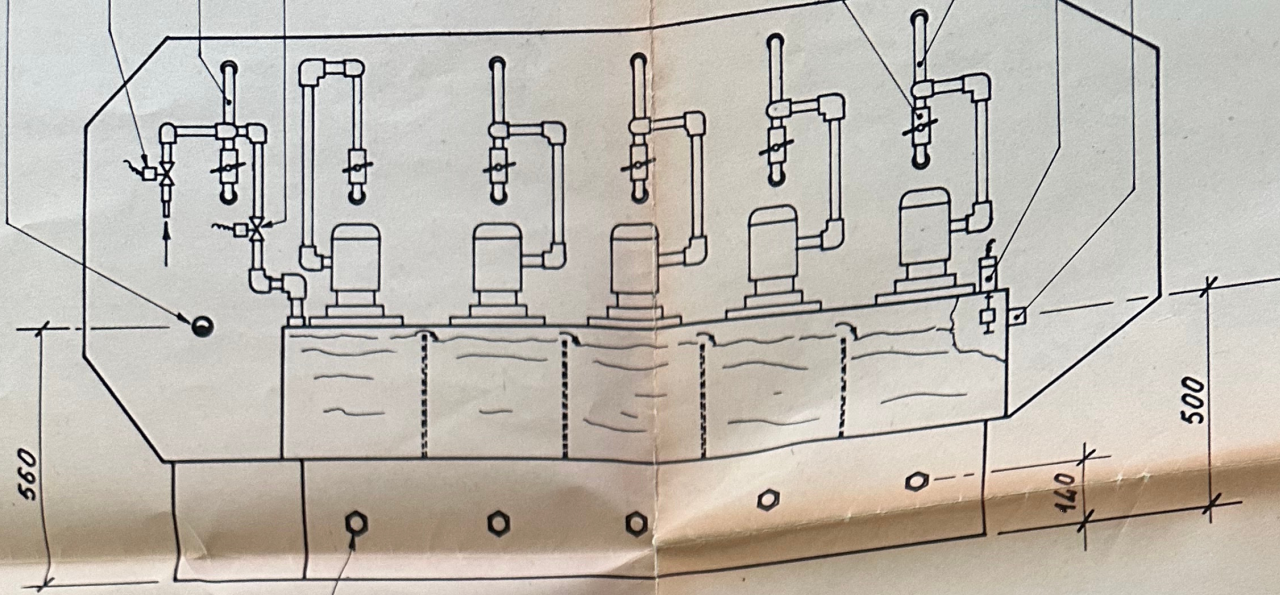

Detail of movement system

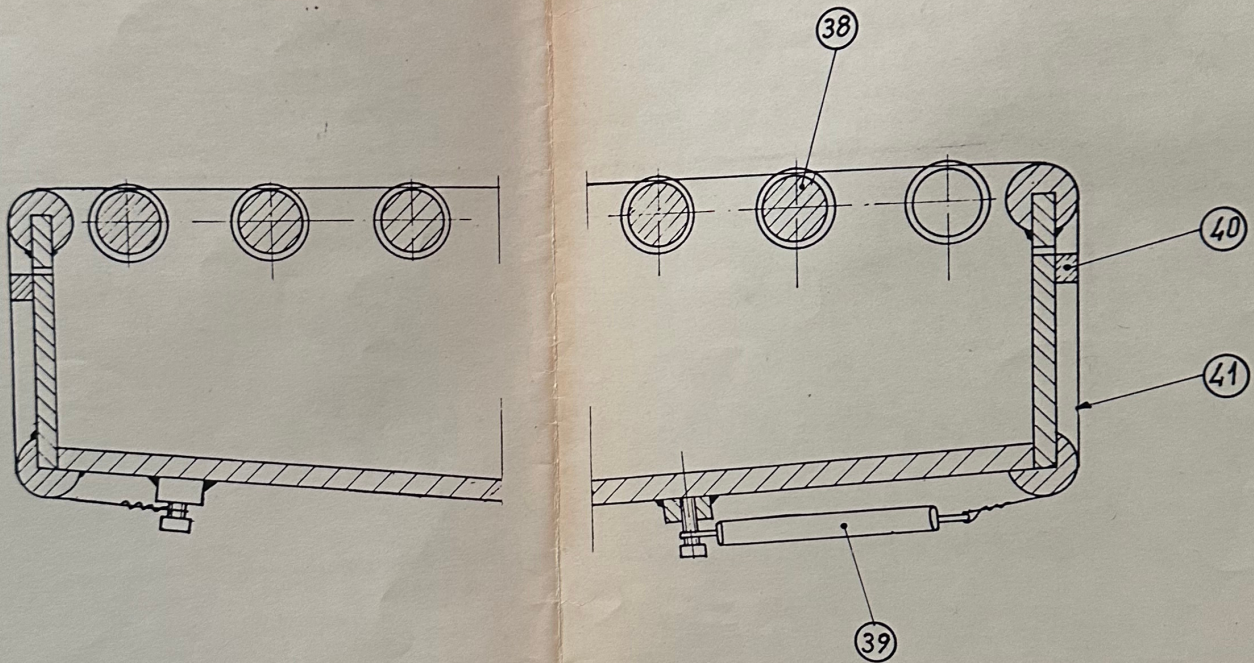

Conveyor system for flexible boards

| | |
|--------|----------|
| MLTR 1 | 91200181 |
| MLTR 2 | 91200182 |
| MLTR 3 | 91200183 |
| MLTR 4 | 91200184 |

RESCO MATTHAES S.R.L.

20145 MILAN - ITALY
 VIA MASSENA 2/A
 PHONE (02) 315140 - 3491022
 TELEX 333264 - FAX 3315381

DESCRIPTION :

RINSING MODULES

SHEET :
 1 / 1

DWG. N.

912MO

RESCO PROPERTY - REPRODUCTION AND DIVULGATION FORBIDDEN



Leiterplattentechnik / Industrievertrieb